



kaniwa
COURT



Where opportunity
meets growth





Kaniwa Court is more than just a residence- it's an opportunity to live, invest and grow in one of Accra's most desirable neighbourhoods. Whether you are a budding investor or young professional, Kaniwa Court promises a lifestyle of comfort and convenience at great value with prices starting at **\$1,584** per month over **36 months**.





Kaniwa Court is an exceptional residential development offering studio, 1-bedroom, and 2-bedroom apartments. Designed with functionality and style in mind, each unit boasts floor-to-ceiling windows, sea-facing balconies, and smart home options.

Whether you're a budding investor or a young professional seeking convenience, Kaniwa Court is where your journey begins.





Conveniently Located

Labone, one of Accra's most desirable neighbourhoods, is home to Kaniwa Court.

It is also adjacent to South La, a historic area with rich culture that is seeing exciting development.

Kaniwa Court offers the best of urban convenience and you're never too far away from anything you need.



DINING & SHOPPING

Rose Garden - 5mins
Bistro 22 - 6 mins
Vine Restaurant - 6 mins
Palace Mall - 6 mins
Fairway - 8 mins
MaxMart - 9 mins



BAR & NIGHTLIFE

Alley Bar - 7 mins
FrontBack - 8 mins
No X Bar & Lounge - 7 mins
Twist Nightclub - 7 mins
Ace Nightclub - 5 mins



RECREATIONAL

Polo Beach Club - 10 mins
Labadi Beach Hotel - 10 mins
Sandbox Beach Club - 7 mins



SCHOOL

Labone Senior High School - 4 mins
Ghana International School - 10 mins
Morning Star School - 7 mins



HEALTH

Akai House Clinic - 10 mins
Olive Health - 11 mins
Euracare - 6 mins



DIPLOMATIC SERVICES & CULTURE

US Embassy - 9 mins
W.E.B Du Bois Centre - 10 mins
Independence Square - 12 mins
Kwame Nkrumah Memorial Park - 20 mins

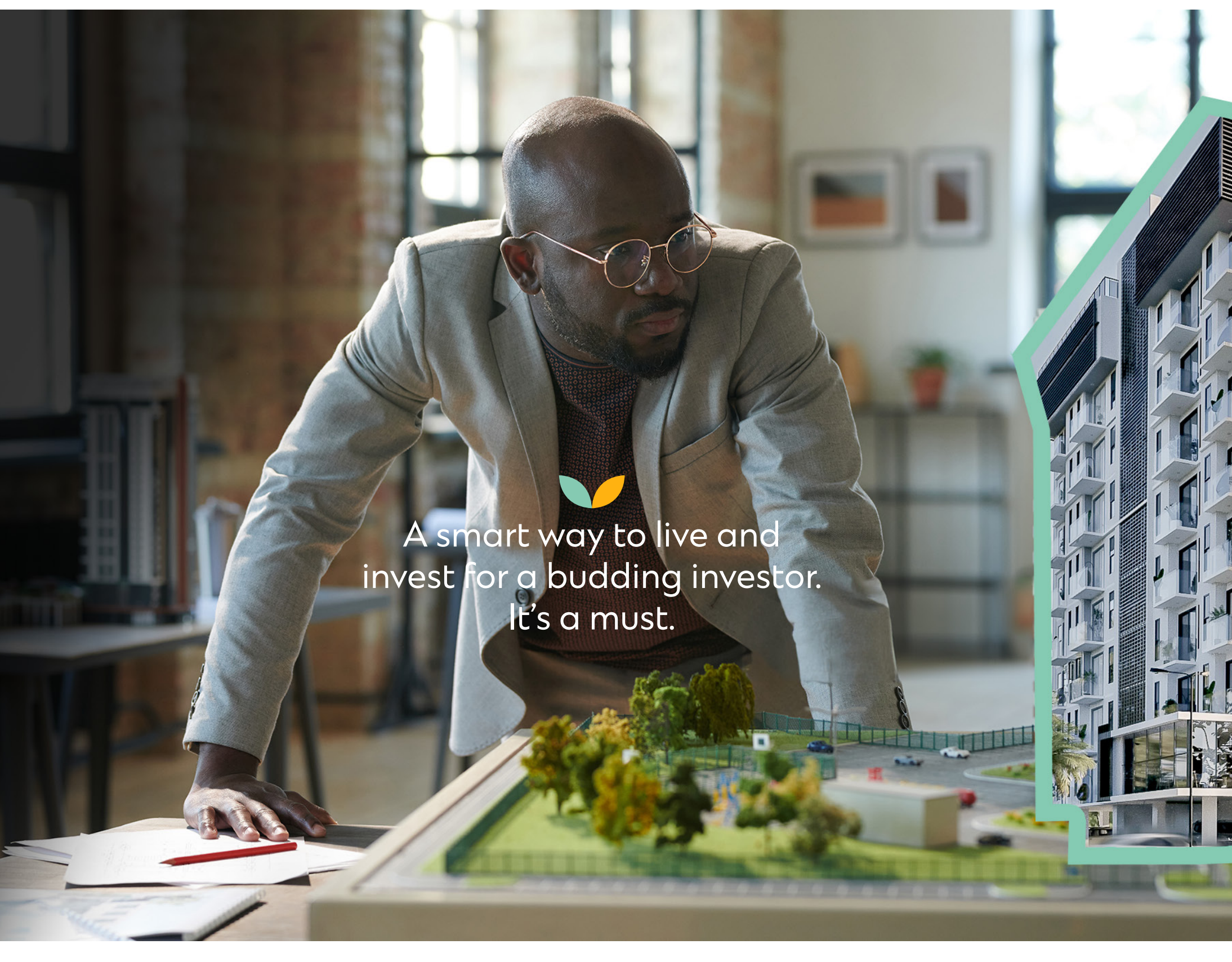

A smart way to live and
invest for a budding investor.
It's a must.





The Investment Opportunity

With properties in Accra appreciating by **10%-15%** over the last 5 years, Labone has been one of the most sought-after locations.

The increase in demand for modern apartments in prime areas and their surrounding neighbourhoods makes Kaniwa Court a **smart investment choice**.

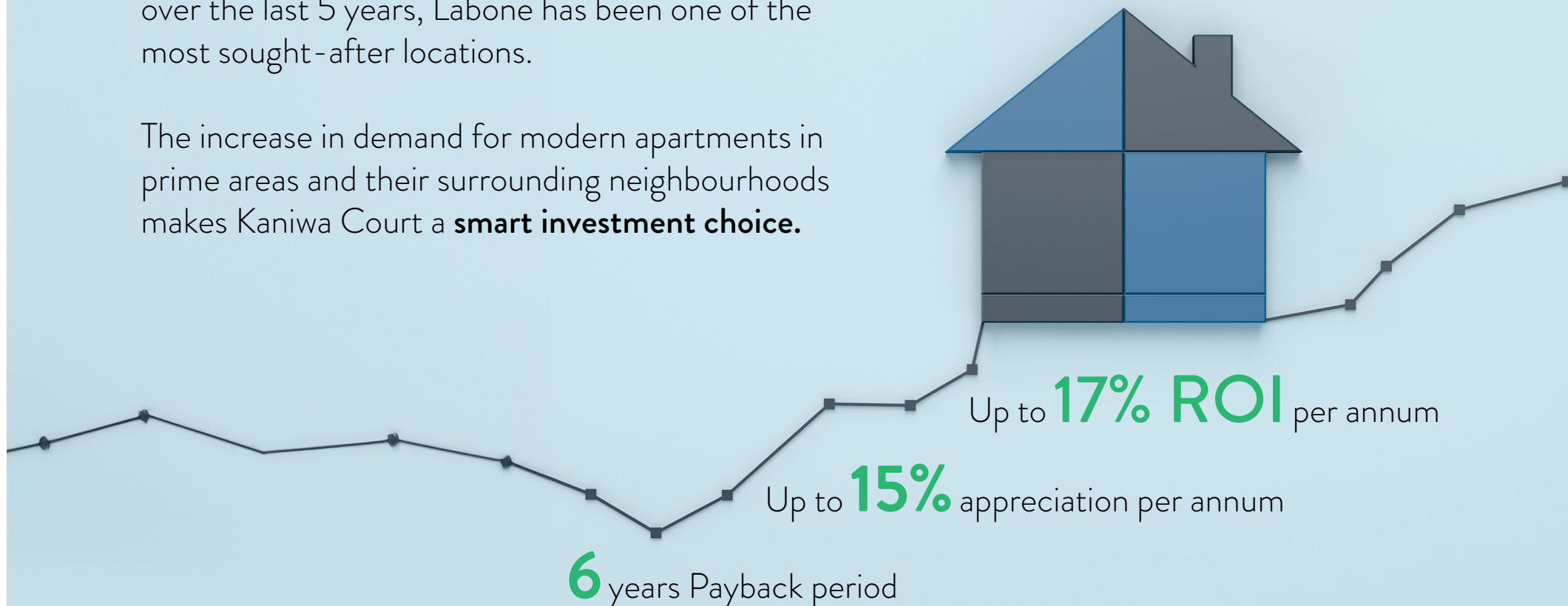



Modern homes for modern living





Choose innovation

Our smart home options include **automated lighting and smart curtains, electrical gadget automation, and advanced smart security features such as remote access control and real-time surveillance.**

These smart features offer unmatched benefits for contemporary living:

- Optimized energy usage
- Savings on energy cost
- Enhanced security
- Stress-free lifestyle

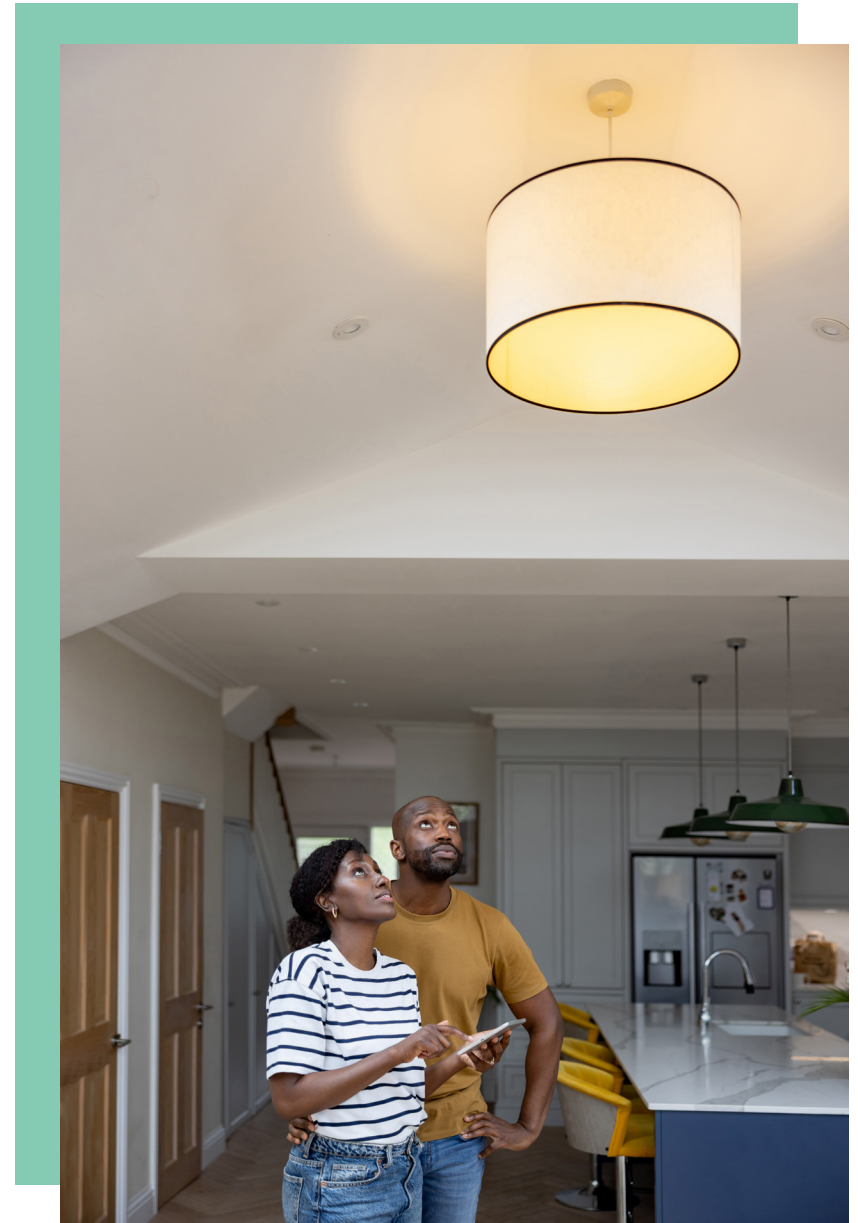



Click on the link to view video walkthrough

 <https://bit.ly/41OR9aV>



Click on the link to view video walkthrough

 <https://bit.ly/41NIRkG>



Click on the link to view video walkthrough

 <https://bit.ly/4fvKcid>



Click on the link to view video walkthrough

 <https://bit.ly/4gtJMKF>

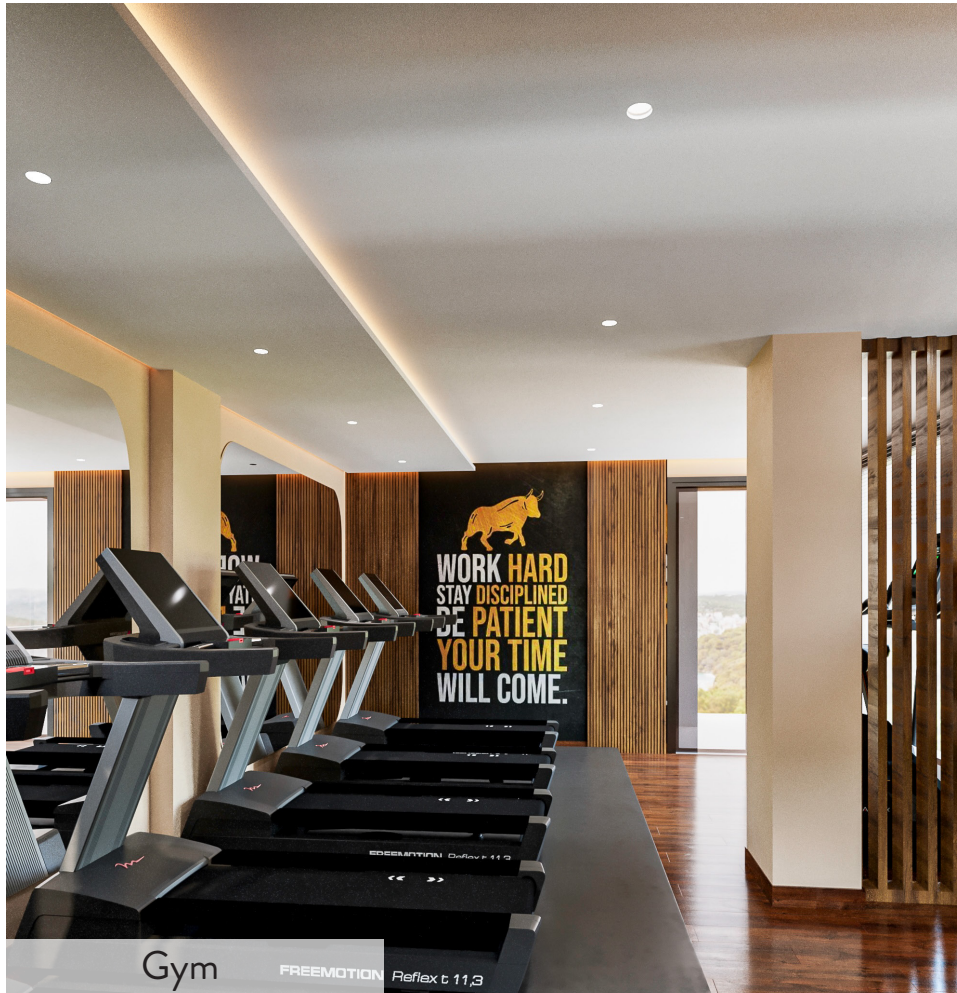

Click on the link to view video walkthrough



<https://bit.ly/4gsK6sR>



Each unit at Kaniwa Court benefits from:



Cafe



Club House



Contemporary fitted
kitchen with appliances
(fridge, hob, oven
& extractor hood)



Air conditioning
units throughout



Backup Generator



Lift



Reception



Basement
Parking



CCTV & 24hr
security



Backup water



Resident
only gym



Optional Smart
Features



Resident only
swimming pool



Car Lift



Facilities
management

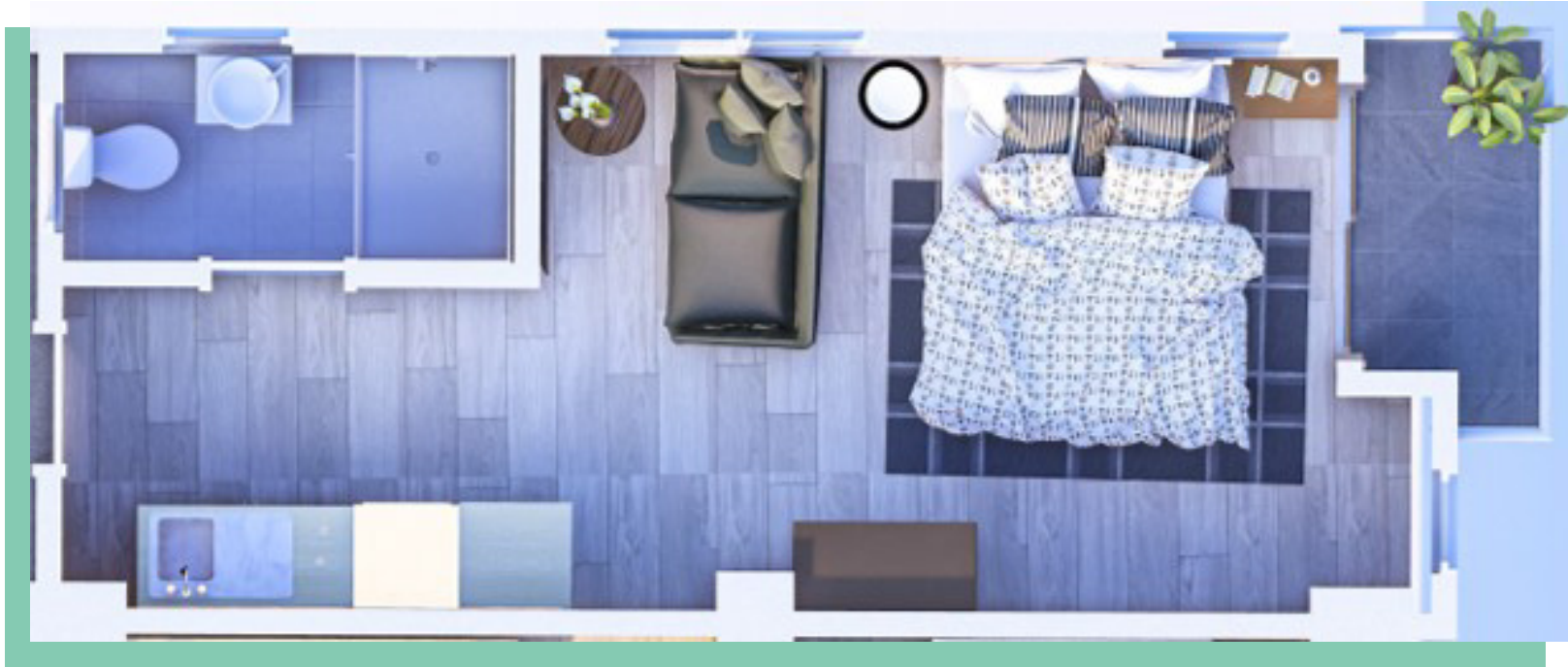

Designed for functionality and modernity, Kaniwa Court offers a range of competitively priced studios, 1 or 2 bed apartments with a range of views – **Accra city to the north, east & west or the Atlantic Ocean.**

Choose the layout and views that suit you



Studio Apartments

Starting

Price: \$68,000

- Ocean views

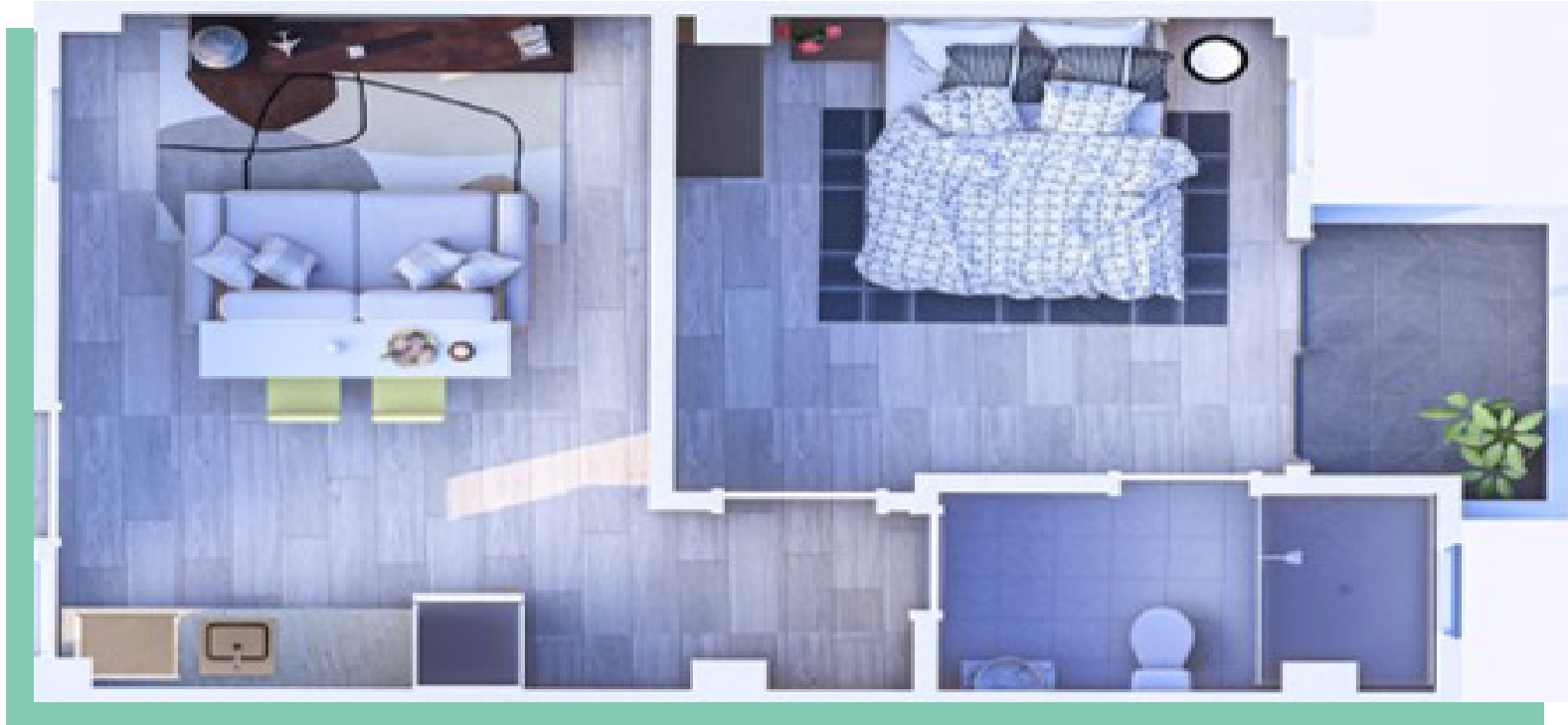

1 bed Apartments

Starting

Price: \$96,000

- Ocean views



2 bed Apartments

Starting

Price: \$187,000

- Ocean views



Payment plan

Our payment terms are flexible and you need only **5%** to sign off. The balance can be spread over **36 months** in either monthly, quarterly or semi-annual instalments with prices starting from **\$1,584 per month.**

✉ Email us: sales@signumdevelopment.com
☎ Call or Whatsapp 0501429981 / 0501602410



@signumdevelopment

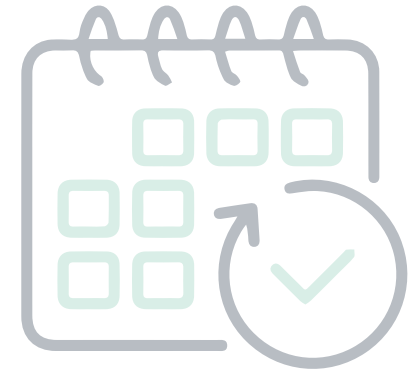

The developer

Signum means something that marks or identifies or represents: sign, signature. Therefore our philosophy is to provide our clients with signature homes that reflect who they are. We have provided bespoke homes since 2000, turning dreams into many homes. We believe in providing beautiful contemporary designs at unbeatable prices without compromising quality.

Disclaimer: The material contained in this brochure is provided for information only and neither the provision of such material nor its access by any person shall be deemed to give rise to any commitment or obligation on the part of Signum Development Limited or any of its subsidiaries or affiliates.

www.signumdevelopment.com



Kaniwa Court is developed by Signum Development